

## Super Heavy Duty

TR-7532, TR-7526, TR-7526-120 and TR-8026



Thomas Regout International B.V. offers a broad range of linear motion solutions that help move your application in any direction: horizontal, vertical or diagonal.

Challenge us, in any way. We will present an innovative and integrated total solution, completely adapted to your specific needs and demands. In our own R&D department we design innovative sliding and linear motion systems. Incorporating the highest ISO international and environmental standards that ensure that our products and services are safe, reliable, sustainable and of high quality.

## Super Heavy Duty

Together with our UK partner we developed a heavy duty range up to 430 kg. These 4 types of heavy duty slides, together with the TR-7619, complete and enlarge our heavy duty slide program for applications such as; military and rescue vehicle drawers and pull outs, fire trucks, machine guarding, battery trays for trains and door systems. The telescopic slides are manufactured from cold drawn and rolled C45 carbon steel, with an aircraft grade aluminium as an option. The bearings and ball cages are made from grade 304 stainless steel. Steel beams are electro galvanised (microns for 72 hrs salt spray test) for best surface protection. Plating is RoHS compliant. We are still in the process of implementing a global stock programme with our partner.



TR-7532



TR-7526 and TR-7526-120



TR-8026

### features and benefits

- 1 Extreme load capacity up to 430 kg
- 2 Very robust design
- 3 2% deflection
- 4 Smooth and play free movement
- 5 High corrosion resistance
- 6 Standard M6/M8 fixation
- 7 Long life time under severe conditions



# Technical specifications

TR-7532

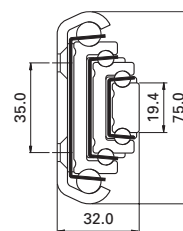
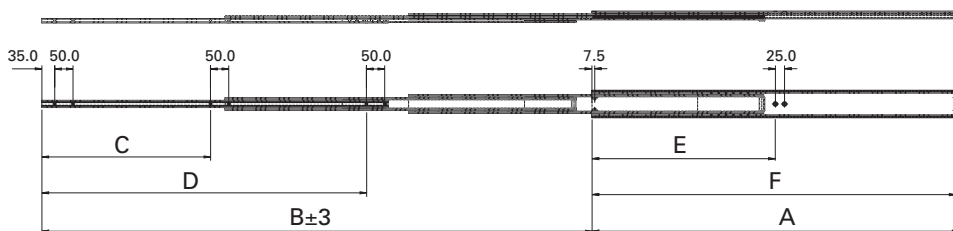

## TR-7532 150% extension (4 beam)

Article number	Installation length "A"	Extension length "B"	Load capacity per pair	Drill table			
				"C"	"D"	"E"	"F"
13875S61	300	450	150 kg	-	185	-	292.5
13875S62	350	525	184 kg	-	235	-	342.5
13875S63	400	600	212 kg	160	285	200	392.5
13875S64	450	675	224 kg	185	335	225	442.5
13875S65	500	750	232 kg	210	285	250	492.5
13875S66	550	825	240 kg	235	435	275	542.5
13875S67	600	900	250 kg	260	485	300	592.5
13875S68	650	975	235 kg	285	535	325	642.5
13875S69	700	1050	220 kg	310	585	350	692.5
13875S70	750	1125	200 kg	335	635	375	742.5
13875S71	800	1200	180 kg	360	685	400	792.5
13875S72	850	1275	160 kg	385	735	425	842.5
13875S73	900	1350	140 kg	410	785	450	892.5
13875S74	950	1425	120 kg	435	835	475	942.5
13875S75	1000	1500	100 kg	460	885	500	992.5

Slides are partially deliverable from stock, please contact sales team.



# Super Heavy Duty

## TR-7526 and TR-7526-120

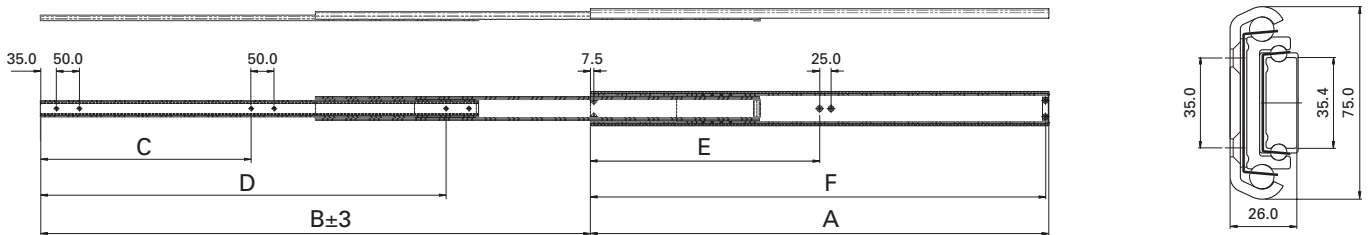

### TR-7526 100% extension

Art. nr.	Installation length "A"	Extension length "B"	Load cap. per pair
13875S01	300	310	360 kg
13875S02	350	360	380 kg
13875S03	400	410	390 kg
13875S04	450	460	400 kg
13875S05	500	510	410 kg
13875S06	550	560	420 kg
13875S07	600	610	430 kg
13875S08	650	660	420 kg
13875S09	700	710	410 kg
13875S10	750	760	400 kg
13875S11	800	810	390 kg
13875S12	850	860	380 kg
13875S13	900	910	370 kg
13875S14	950	960	360 kg
13875S15	1000	1010	350 kg
13875S17	1100	1110	320 kg
13875S19	1200	1210	300 kg
13875S21	1300	1310	280 kg
13875S23	1400	1410	260 kg
13875S25	1500	1510	240 kg

### TR-7526-120 120% extension

Art. nr.	Installation length "A"	Extension length "B"	Load cap. per pair
13875S31	300	360	324 kg
13875S32	350	420	342 kg
13875S33	400	480	351 kg
13875S34	450	540	360 kg
13875S35	500	600	369 kg
13875S36	550	660	378 kg
13875S37	600	720	387 kg
13875S38	650	780	378 kg
13875S39	700	840	369 kg
13875S40	750	900	360 kg
13875S41	800	960	351 kg
13875S42	850	1020	342 kg
13875S43	900	1080	333 kg
13875S44	950	1140	324 kg
13875S45	1000	1200	315 kg
13875S47	1100	1320	288 kg
13875S49	1200	1440	270 kg
13875S51	1300	1560	252 kg
13875S53	1400	1680	234 kg
13875S55	1500	1800	216 kg

Drill table			
"C"	"D"	"E"	"F"
-	185	-	292.5
-	235	-	342.5
-	285	-	392.5
-	335	-	442.5
-	285	-	492.5
235	435	275	542.5
260	485	300	592.5
285	535	325	642.5
310	585	350	692.5
335	635	375	742.5
360	685	400	792.5
385	735	425	842.5
410	785	450	892.5
435	835	475	942.5
460	885	500	992.5
510	985	550	1092.5
560	1085	600	1192.5
610	1185	650	1292.5
660	1285	700	1392.5
710	1385	750	1492.5

Slides are partially deliverable from stock, please contact sales team.

## Technical specifications

TR-8026

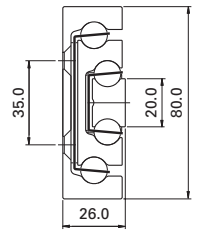
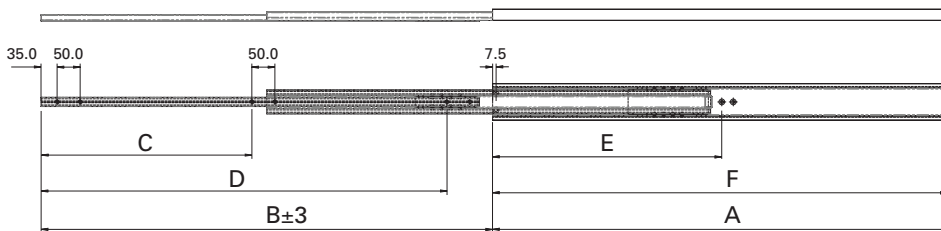

### TR-8026 (aluminium) 100% extension

Article number	Installation length "A"	Extension length "B"	Load capacity per pair	Drill table			
				"C"	"D"	"E"	"F"
13880S01	300	285	250 kg	-	185	150	292.5
13880S02	350	335	260 kg	-	235	175	342.5
13880S03	400	385	270 kg	-	285	200	392.5
13880S04	450	435	280 kg	-	335	225	442.5
13880S05	500	485	300 kg	-	285	250	492.5
13880S06	550	535	320 kg	235	435	275	542.5
13880S07	600	585	330 kg	260	485	300	592.5
13880S08	650	635	315 kg	285	535	325	642.5
13880S09	700	685	300 kg	310	585	350	692.5
13880S10	750	735	290 kg	335	635	375	742.5
13880S11	800	785	280 kg	360	685	400	792.5
13880S12	850	835	270 kg	385	735	425	842.5
13880S13	900	885	260 kg	410	785	450	892.5
13880S14	950	935	250 kg	435	835	475	942.5
13880S15	1000	985	240 kg	460	885	500	992.5

Slides are partially deliverable from stock, please contact sales team.



---

**Thomas Regout International B.V.**

Industrieweg 40  
6219 NR Maastricht  
The Netherlands

T. +31 (0)43 351 66 66

F. +31 (0)43 351 66 99

E. [sales@tregout.nl](mailto:sales@tregout.nl)

---

[www.thomasregout.com](http://www.thomasregout.com)

