

## STRAUB-COMBI-GRIP Ø 40.0 - 160.0 mm

Components / Materials	W1	W2	W4	W5
Casing		AISI 304	AISI 304	
Bolts		AISI 4135	A4 - 80	
Bars		AISI 12 L 14, galvanised	AISI 304	
Anchoring rings		AISI 301 / 304	AISI 304	
Strip insert (option)		AISI 316 L / PVDF	AISI 316 L / PVDF	
<b>Sealing sleeve</b> <b>EPDM</b>	Temp.: -20°C up to +100°C Medium: all qualities of water, waste water, air, solids and chemical products			
<b>Sealing sleeve</b> <b>NBR</b>	Temp.: -20°C up to +80°C Medium: water, gas, oil, fuel and other hydrocarbons			

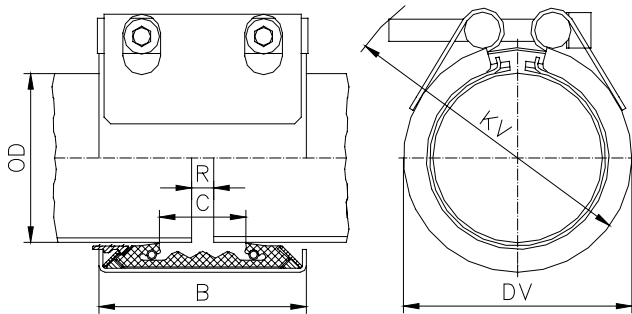

OD [mm]	Clamping range Plastic [mm]   Metal [mm]	PS [bar]	B [mm]	C [mm]	DV [mm]	KV [mm]	R without strip insert [mm]	R with strip insert [mm]	Torque rate [Nm]	Allen head [mm]	Thread M...
40.0/38.0	39.0 - 40.5   37.5 - 39.0	16.0	61	19	60	90	5	5-10	15	6	8
<b>40.0/42.4</b>	<b>39.0 - 40.5   42.0 - 43.5</b>	<b>16.0</b>	<b>61</b>	<b>20</b>	<b>63</b>	<b>95</b>	<b>5</b>	<b>5-10</b>	<b>15</b>	<b>6</b>	<b>8</b>
50.0/48.3	49.0 - 50.5   47.8 - 49.0	16.0	61	26	70	100	5	5-10	15	6	8
63.0/60.3	62.0 - 64.0   59.7 - 61.0	16.0	76	32	85	115	5-10	5-25	20	6	8
75.0/76.1	74.0 - 76.0   75.0 - 77.5	16.0	94	39	100	137	5-10	5-25	25	8	10
90.0/88.9	89.0 - 91.0   87.0 - 90.0	16.0	94	39	118	152	5-10	5-25	25	8	10
110.0/108.0	109.0 - 111.0   106.5 - 110.5	16.0	94	39	135	167	5-10	5-25	25	8	10
<b>110.0/114.3</b>	<b>109.0 - 111.0   112.0 - 116.0</b>	<b>16.0</b>	<b>97</b>	<b>45</b>	<b>139</b>	<b>172</b>	<b>5-10</b>	<b>5-25</b>	<b>25</b>	<b>8</b>	<b>10</b>
114.3/114.3	113.0 - 115.0   112.0 - 116.0	16.0	94	39	140	177	5-10	5-25	25	8	10
<b>140.0/139.7</b>	<b>139.0 - 142.0   137.5 - 141.0</b>	<b>16.0</b>	<b>109</b>	<b>43</b>	<b>168</b>	<b>200</b>	<b>5-15</b>	<b>5-30</b>	<b>60</b>	<b>10</b>	<b>12</b>
160.0/159.0 <sup>1</sup>	159.0 - 162.0   157.0 - 160.5	16.0	109	43	188	215	5-15	5-30	60	10	12

### Remarks:

- Follow fitting / disassembly instructions
- PS = Working pressure considering the application loads  
Test pressure = PS x 1.5 (for example industry, water supply etc.)
- For the installation of pipes of pipes made of HDPE and PP, STRAUB stiffening rings are required
- Strip inserts are required for special applications

<sup>1</sup> Available in version W2 only

For IPS sizes in bold see technical manual for actual OD